

**Dodge / Chrysler 1994-1998 1/2**

**Model 80 /286 Rear Axles for**

**D2500, D3500**

**W2500**

**Sweptline Vehicle**

# Dodge Model 80 /286 Rear Axles Exploded View

X510-9

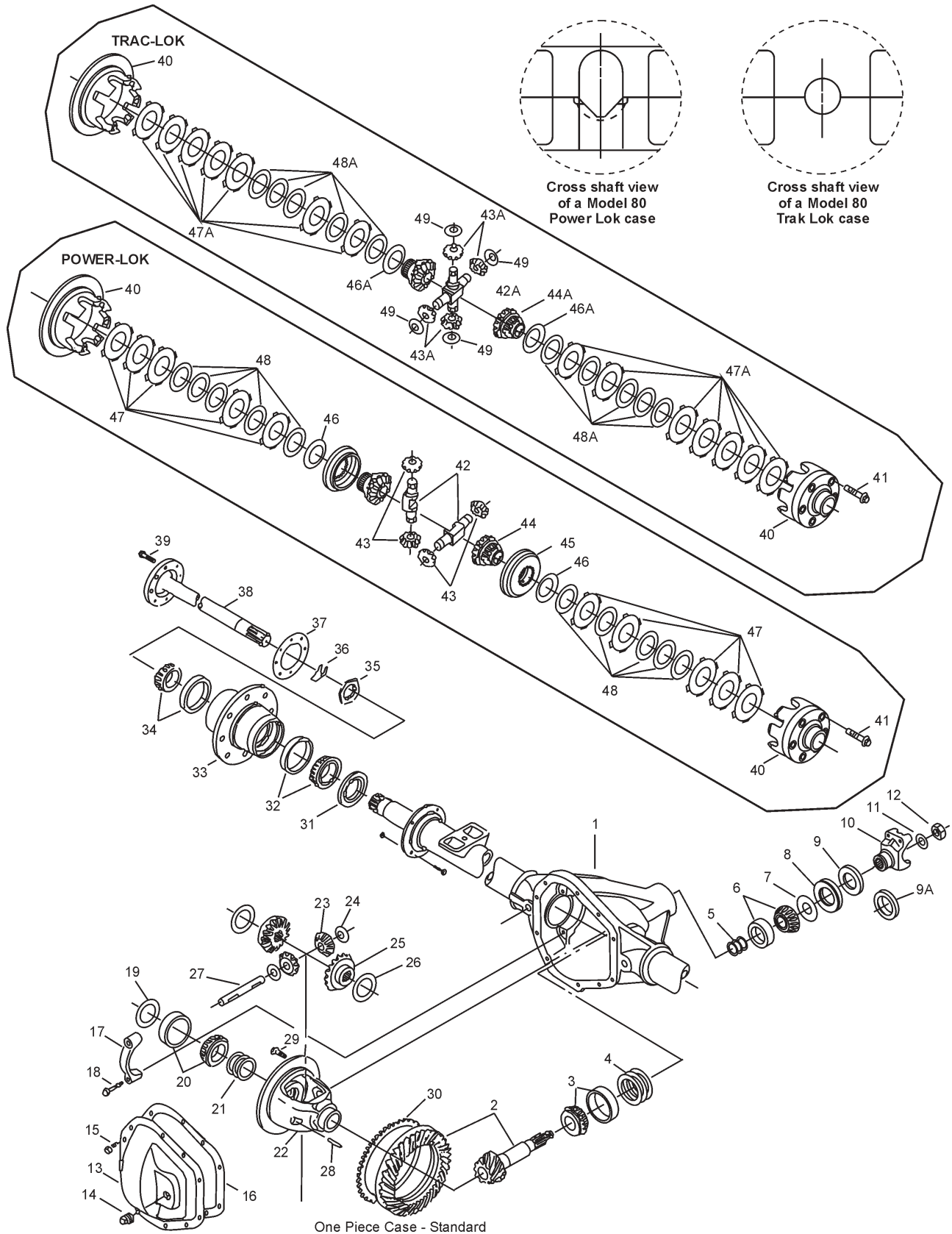

# Dodge Model 80 /286 Rear Axles Parts Listing

ITEM NO.	PART NUMBER	DESCRIPTION	ITEM NO.	PART NUMBER	DESCRIPTION
1	— <sup>(3)</sup>	Housing – Axle Service	26	34729	Thrustwasher – Differential Gear
2	— <sup>(1)</sup>	Drive Pinion & Gear Assembly	27	46640	Shaft – Differential
3	707065X	KIT – Inner Pinion Bearing	28	47024	Lock – Differential Shaft
	707066X	PKG – Pinion Bearing Shim (inc items 4, 5, 11, 12)	29	42433	Bolt – Drive Gear
	708036	PKG – Diff & Pinion Bearing Shim (inc items 4, 5, 11, 12, 21)	30	42414	Tone Ring (ABS)
4	— <sup>(4)</sup>	Inner Pinion Shims (see shim packages)	31	— <sup>(2)</sup>	Seal – Hub
5	— <sup>(4)</sup>	Outer Pinion Shims (see shim packages)	32	— <sup>(3)</sup>	KIT – Inner Wheel Bearing
6	707064X	KIT – Outer Pinion Bearing	33	— <sup>(3)</sup>	Hub Assembly
7	42430	Thrustwasher – Bearing	34	— <sup>(3)</sup>	KIT – Outer Wheel Bearing
8	— <sup>(2)</sup>	Seal – Pinion Oil	35	— <sup>(2)</sup>	Spindle Nut
9	231872	Seal – Deflector	36	46545	Locking Wedge
10	3-4-11081-1X	End Yoke Assembly (inc 9)	37	39697	Gasket
11	37104	Washer – Pinion Nut	38	— <sup>(1)</sup>	Shaft – Axle
12	37082	Pinion Nut	39	— <sup>(2)</sup>	Flange Head Screw
	— <sup>(2)</sup>	KIT – Carrier Cover (inc items 13, 14, 15)	40	— <sup>(1)</sup>	Case – Differential (p/l / t/l)
13	— <sup>(2)</sup>	Carrier Cover	41	41610-1	Flange Head Screw
14	38637	Plug – Carrier Cover	42	070SS105	Shaft – Differential (p/l)
15	34822	Bolt – Carrier Cover	42A	47802	Shaft – Differential (t/l)
16	38615	RTV Silicone Sealant	43	31040	Pinion – Differential (p/l)
17	— <sup>(3)</sup>	Differential Bearing Cap	43A	47798	Pinion – Differential (t/l)
18	48632-1	Bolt – Differential Bearing Cap	44	46394	Gear – Differential (p/l)
19	707069X	KIT – Outboard Bearing Spacer	44A	47796	Gear – Differential (t/l)
20	706070X	KIT – Differential Bearing	45	46395	Ring – Differential Gear (p/l)
21	708035	PKG – Differential Bearing Shim		701129X <sup>(5)</sup>	KIT – Disc & Plate (t/l)
22	— <sup>(1)</sup>	Case – Differential (std)		702009 <sup>(5)</sup>	KIT – Disc & Plate (p/l)
23	42413	Pinion – Differential (std)	46	— <sup>(4)</sup>	Disc – Differential Dished (p/l)
24	35082	Thrustwasher – Differential Pinion	46A	— <sup>(4)</sup>	Disc – Differential Dished (t/l)
25	42411	Gear – Differential (std)	47	— <sup>(4)</sup>	Plate – Differential Pressure (p/l)
			47A	— <sup>(4)</sup>	Plate – Differential Pressure (t/l)
			48	— <sup>(4)</sup>	Disc – Differential Clutch (p/l)
			48A	— <sup>(4)</sup>	Disc – Differential Clutch (t/l)
			49	—	Thrustwasher – Pinion Diff (t/l)

(1) See "Bill of Material Table" on next page

(2) See "Variable Parts Table" within this section

(3) Contact Vehicle Manufacturer

(4) Not Sold Separately

(5) Service Power Lok ratios 3.54 Case Assembly or Case Kit with 708054 Trak Lok  
Service Power Lok ratios 4.10 Case Assembly or Case Kit with 708052 Trak Lok  
The 708054 & 708052 Trak Lok uses 708051 Inner Parts Kit

Note: See cross shaft view illustration on previous page for the difference between a Power Lok and a Trak Lok case.

# Dodge Model 80 /286 Rear Axles

## Bill of Material Table

Axle			Axle Kits				Shaft & Joint Assy.	
Bill of Material	Diff. Type	Ratio	Ring Gear & Pinion Kit <sup>(7)</sup>	Differential			Right Hand Shaft Assy.	Left Hand Shaft Assy.
				Case Assy. Kit <sup>(8)</sup>	Case Kit	Inner Parts Kit		
<b>1994-95 1/2 D2500 w/ABS</b>								
605595-1	Standard	3.54	708026-1	708027	708028	707063X	45553-1	45553-1
605595-2	Powr Lok	3.54	708026-1	708029 <sup>(9)</sup>	708030 <sup>(9)</sup>	707358X <sup>(9)</sup>	45553-1	45553-1
605595-3	Standard	4.10	708026-2	708031	708032	707063X	45553-1	45553-1
605595-6	Standard	3.54	708026-1	708027	708028	707063X	45553-1	45553-1
605595-8	Standard	4.10	708026-2	708031	708032	707063X	45553-1	45553-1
605595-10	Powr Lok	3.54	708026-1	708029 <sup>(9)</sup>	708030 <sup>(9)</sup>	707358X <sup>(9)</sup>	45553-1	45553-1
605595-11	Powr Lok	4.10	708026-2	708033 <sup>(9)</sup>	708034 <sup>(9)</sup>	707358X <sup>(9)</sup>	45553-1	45553-1
<b>1994-95 1/2 D3500 w/ABS</b>								
605593-1	Standard	3.54	708026-1	708027	708028	707063X	45553-2	45553-2
605593-2	Powr Lok	3.54	708026-1	708029 <sup>(9)</sup>	708030 <sup>(9)</sup>	707063X	45553-2	45553-2
605593-3	Standard	4.10	708026-2	708031	708032	707063X	45553-2	45553-2
605593-8	Standard	4.10	708026-2	708031	708032	707063X	45553-2	45553-2
605593-9	Standard	3.54	708026-1	708027	708028	707063X	45553-2	45553-2
605593-12	Standard	4.10	708026-2	708031	708032	707063X	45553-2	45553-2
605593-13	Powr Lok	3.54	708026-1	708029 <sup>(9)</sup>	708030 <sup>(9)</sup>	707358X <sup>(9)</sup>	45553-2	45553-2
605593-14	Powr Lok	4.10	708026-2	708033 <sup>(9)</sup>	708034 <sup>(9)</sup>	707358X <sup>(9)</sup>	45553-2	45553-2
<b>1994-95 1/2 D3500 &amp; W3500 w/ABS</b>								
605594-1	Standard	3.54	708026-1	708027	708028	707063X	45553-3	45553-3
605594-2	Powr Lok	3.54	708026-1	708029 <sup>(9)</sup>	708030 <sup>(9)</sup>	707358X <sup>(9)</sup>	45553-3	45553-3
605594-3	Standard	4.10	708026-2	708031	708032	707063X	45553-3	45553-3
605594-7	Standard	3.54	708026-1	708027	708028	707063X	45553-3	45553-3
605594-9	Standard	4.10	708026-2	708031	708032	707063X	45553-3	45553-3
605594-11	Powr Lok	3.54	708026-1	708029 <sup>(9)</sup>	708030 <sup>(9)</sup>	707358X <sup>(9)</sup>	45553-3	45553-3
605594-12	Powr Lok	4.10	708026-2	708033 <sup>(9)</sup>	708034 <sup>(9)</sup>	707358X <sup>(9)</sup>	45553-3	45553-3
<b>1994-95 1/2 W2500 w/ABS</b>								
605596-1	Standard	3.54	708026-1	708027	708028	707063X	45553-1	45553-1
605596-2	Powr Lok	3.54	708026-1	708029 <sup>(9)</sup>	708030 <sup>(9)</sup>	707358X <sup>(9)</sup>	45553-1	45553-1
605596-3	Standard	4.10	708026-2	708031	708032	707063X	45553-1	45553-1
605596-6	Standard	3.54	708026-1	708027	708028	707063X	45553-1	45553-1
605596-8	Standard	4.10	708026-2	708031	708032	707063X	45553-1	45553-1
605596-10	Powr Lok	3.54	708026-1	708029 <sup>(9)</sup>	708030 <sup>(9)</sup>	707358X <sup>(9)</sup>	45553-1	45553-1
605596-11	Powr Lok	4.10	708026-2	708033 <sup>(9)</sup>	708034 <sup>(9)</sup>	707358X <sup>(9)</sup>	45553-1	45553-1
<b>1994-95 1/2 W3500 w/ABS</b>								
605592-1	Standard	3.54	708026-1	708027	708028	707063X	45553-2	45553-2
605592-2	Powr Lok	3.54	708026-1	708029 <sup>(9)</sup>	708030 <sup>(9)</sup>	707358X <sup>(9)</sup>	45553-2	45553-2
605592-3	Standard	4.10	708026-2	708031	708032	707063X	45553-2	45553-2
605592-8	Standard	4.10	708026-2	708031	708032	707063X	45553-2	45553-2
605592-9	Standard	3.54	708026-1	708027	708028	707063X	45553-2	45553-2
605592-12	Standard	4.10	708026-2	708031	708032	707063X	45553-2	45553-2
605592-13	Powr Lok	3.54	708026-1	708029 <sup>(9)</sup>	708030 <sup>(9)</sup>	707358X <sup>(9)</sup>	45553-2	45553-2
605592-14	Powr Lok	4.10	708026-2	708033 <sup>(9)</sup>	708034 <sup>(9)</sup>	707358X <sup>(9)</sup>	45553-2	45553-2
<b>1995-97 Sweptline Vehicle</b>								
605718-1	Standard	3.54	708026-1	708027	708028	707063X	45553-2	45553-2
605718-2	Powr Lok	3.54	708026-1	708029 <sup>(9)</sup>	708030 <sup>(9)</sup>	707358X <sup>(9)</sup>	45553-2	45553-2
605718-3	Standard	4.10	708026-2	708031	708032	707063X	45553-2	45553-2
605718-4	Powr Lok	4.10	708026-2	708033 <sup>(9)</sup>	708034 <sup>(9)</sup>	707358X <sup>(9)</sup>	45553-2	45553-2

(7) See Ring Gear & Pinion Kits in XGI Catalog for ratio & tooth combinations.

(8) See Differential Case Assy Kits in XGI Catalog for spline data & ratios.

(9) Service Power Lok ratios 3.54 Case Assembly or Case Kit with 708054 Trak Lok.

Service Power Lok ratios 4.10 Case Assembly or Case Kit with 708052 Trak Lok.

The 708054 & 708052 Trak Lok uses 708051 Inner Parts Kit.

Note: See cross shaft view illustration on previous page for the difference between a Power Lok and a Trak Lok case.

# Dodge Model 80 /286 Rear Axles

## Bill of Material Table

Axle			Axle Kits				Shaft & Joint Assy.	
Bill of Material	Diff. Type	Ratio	Ring Gear & Pinion Kit <sup>(7)</sup>	Differential			Right Hand Shaft Assy.	Left Hand Shaft Assy.
				Case Assy. Kit <sup>(8)</sup>	Case Kit	Inner Parts Kit		
<b>1996-96 1/2 D2500</b>								
605791-1	Standard	3.54	708026-1	708027	708028	707063X	45553-1	45553-1
605791-2	Standard	4.10	708026-2	708031	708032	707063X	45553-1	45553-1
605791-3	Powr Lok	3.54	708026-1	708029 <sup>(9)</sup>	708030 <sup>(9)</sup>	707358X <sup>(9)</sup>	45553-1	45553-1
605791-4	Powr Lok	4.10	708026-2	708033 <sup>(9)</sup>	708034 <sup>(9)</sup>	707358X <sup>(9)</sup>	45553-1	45553-1
<b>1996-96 1/2 D3500 w/ABS</b>								
605789-1	Standard	3.54	708026-1	708027	708028	707063X	45553-2	45553-2
605789-2	Standard	4.10	708026-2	708031	708032	707063X	45553-2	45553-2
605789-3	Powr Lok	3.54	708026-1	708029 <sup>(9)</sup>	708030 <sup>(9)</sup>	707358X <sup>(9)</sup>	45553-2	45553-2
605789-4	Powr Lok	4.10	708026-2	708033 <sup>(9)</sup>	708034 <sup>(9)</sup>	707358X <sup>(9)</sup>	45553-2	45553-2
605789-5	Standard	3.54	708026-1	708027	708028	707063X	45553-2	45553-2
605789-6	Standard	4.10	708026-2	708031	708032	707063X	45553-2	45553-2
605789-7	Powr Lok	3.54	708026-1	708029 <sup>(9)</sup>	708030 <sup>(9)</sup>	707358X <sup>(9)</sup>	45553-2	45553-2
605789-8	Powr Lok	4.10	708026-2	708033 <sup>(9)</sup>	708034 <sup>(9)</sup>	707358X <sup>(9)</sup>	45553-2	45553-2
<b>1996-96 1/2 D3500 &amp; W3500 w/ABS</b>								
605790-1	Standard	3.54	708026-1	708027	708028	707063X	45553-3	45553-3
605790-2	Standard	4.10	708026-2	708031	708032	707063X	45553-3	45553-3
605790-3	Powr Lok	3.54	708026-1	708029 <sup>(9)</sup>	708030 <sup>(9)</sup>	707358X <sup>(9)</sup>	45553-3	45553-3
605790-4	Powr Lok	4.10	708026-2	708033 <sup>(9)</sup>	708034 <sup>(9)</sup>	707358X <sup>(9)</sup>	45553-3	45553-3
605790-5	Standard	3.54	708026-1	708027	708028	707063X	45553-3	45553-3
605790-6	Standard	4.10	708026-2	708031	708032	707063X	45553-3	45553-3
605790-7	Powr Lok	3.54	708026-1	708029 <sup>(9)</sup>	708030 <sup>(9)</sup>	707358X <sup>(9)</sup>	35553-3	35553-3
605790-8	Powr Lok	4.10	708026-2	708033 <sup>(9)</sup>	708034 <sup>(9)</sup>	707358X <sup>(9)</sup>	45553-3	45553-3
<b>1996-96 1/2 W3500</b>								
605788-1	Standard	3.54	708026-1	708027	708028	707063X	45553-2	45553-2
605788-2	Standard	4.10	708026-2	708031	708032	707063X	45553-2	45553-2
605788-3	Powr Lok	3.54	708026-1	708029 <sup>(9)</sup>	708030 <sup>(9)</sup>	707358X <sup>(9)</sup>	45553-2	45553-2
605788-4	Powr Lok	4.10	708026-2	708033 <sup>(9)</sup>	708034 <sup>(9)</sup>	707358X <sup>(9)</sup>	45553-2	45553-2
605788-5	Standard	3.54	708026-1	708027	708028	707063X	45553-2	45553-2
605788-6	Standard	4.10	708026-2	708031	708032	707063X	45553-2	45553-2
605788-7	Powr Lok	3.54	708026-1	708029 <sup>(9)</sup>	708030 <sup>(9)</sup>	707358X <sup>(9)</sup>	45553-2	45553-2
605788-8	Powr Lok	4.10	708026-2	708033 <sup>(9)</sup>	708034 <sup>(9)</sup>	707358X <sup>(9)</sup>	45553-2	45553-2
<b>1996 1/2 D2500</b>								
605792-1	Standard	3.54	708026-1	708027	708028	707063X	45553-1	45553-1
605792-2	Standard	4.10	708026-2	708031	708032	707063X	45553-1	45553-1
605792-3	Powr Lok	3.54	708026-1	708029 <sup>(9)</sup>	708030 <sup>(9)</sup>	707358X <sup>(9)</sup>	45553-1	45553-1
605792-4	Powr Lok	4.10	708026-2	708033 <sup>(9)</sup>	708034 <sup>(9)</sup>	707358X <sup>(9)</sup>	45553-1	45553-1
<b>1997 D2500</b>								
605905-1	Standard	3.54	708026-1	708027	708028	707063X	45553-1	45553-1
605905-2	Powr Lok	3.54	708026-1	708029 <sup>(9)</sup>	708030 <sup>(9)</sup>	707358X <sup>(9)</sup>	45553-1	45553-1
605905-3	Standard	4.10	708026-2	708031	708032	707063X	45553-1	45553-1
605905-4	Powr Lok	4.10	708026-2	708033 <sup>(9)</sup>	708034 <sup>(9)</sup>	707358X <sup>(9)</sup>	45553-1	45553-1
<b>1997 W2500</b>								
605906-1	Standard	3.54	708026-1	708027	708028	707063X	45553-1	45553-1
605906-2	Powr Lok	3.54	708026-1	708029 <sup>(9)</sup>	708030 <sup>(9)</sup>	707358X <sup>(9)</sup>	45553-1	45553-1
605906-3	Standard	4.10	708026-2	708031	708032	707063X	45553-1	45553-1
605906-4	Powr Lok	4.10	708026-2	708033 <sup>(9)</sup>	708034 <sup>(9)</sup>	707358X <sup>(9)</sup>	45553-1	45553-1

(7) See Ring Gear & Pinion Kits in XGI Catalog for ratio & tooth combinations.

(8) See Differential Case Assy Kits in XGI Catalog for spline data & ratios.

(9) Service Power Lok ratios 3.54 Case Assembly or Case Kit with 708054 Trak Lok.

Service Power Lok ratios 4.10 Case Assembly or Case Kit with 708052 Trak Lok.

The 708054 & 708052 Trak Lok uses 708051 Inner Parts Kit.

Note: See cross shaft view illustration on previous page for the difference between a Power Lok and a Trak Lok case.

# Dodge Model 80 /286 Rear Axles

## Bill of Material Table

Axle			Axle Kits				Shaft & Joint Assy.	
Bill of Material	Diff. Type	Ratio	Ring Gear & Pinion Kit <sup>(7)</sup>	Differential			Right Hand Shaft Assy.	Left Hand Shaft Assy.
				Case Assy. Kit <sup>(8)</sup>	Case Kit	Inner Parts Kit		
<b>1997 D3500 w/ABS</b>								
605903-1	Standard	3.54	708026-1	708027	708028	707063X	45553-2	45553-2
605903-2	Powr Lok	3.54	708026-1	708029 <sup>(9)</sup>	708030 <sup>(9)</sup>	707358X <sup>(9)</sup>	45553-2	45553-2
605903-3	Standard	4.10	708026-2	708031	708032	707063X	45553-2	45553-2
605903-4	Powr Lok	4.10	708026-2	708033 <sup>(9)</sup>	708034 <sup>(9)</sup>	707358X <sup>(9)</sup>	45553-2	45553-2
<b>1997 D3500 &amp; W3500 w/ABS</b>								
605904-1	Standard	3.54	708026-1	708027	708028	707063X	45553-3	45553-3
605904-2	Powr Lok	3.54	708026-1	708029 <sup>(9)</sup>	708030 <sup>(9)</sup>	707358X <sup>(9)</sup>	45553-3	45553-3
605904-3	Standard	4.10	708026-2	708031	708032	707063X	45553-3	45553-3
605904-4	Powr Lok	4.10	708026-2	708033 <sup>(9)</sup>	708034 <sup>(9)</sup>	707358X <sup>(9)</sup>	45553-3	45553-3
<b>1997 W3500</b>								
605902-1	Standard	3.54	708026-1	708027	708028	707063X	45553-2	45553-2
605902-2	Powr Lok	3.54	708026-1	708029 <sup>(9)</sup>	708030 <sup>(9)</sup>	707358X <sup>(9)</sup>	45553-2	45553-2
605902-3	Standard	4.10	708026-2	708031	708032	707063X	45553-2	45553-2
605902-4	Powr Lok	4.10	708026-2	708033 <sup>(9)</sup>	708034 <sup>(9)</sup>	707358X <sup>(9)</sup>	45553-2	45553-2
<b>1997 1/2 D3500 w/ABS</b>								
605976-1	Standard	3.54	708026-1	708027	708028	707063X	45553-2	45553-2
605976-2	Powr Lok	3.54	708026-1	708029 <sup>(9)</sup>	708030 <sup>(9)</sup>	707358X <sup>(9)</sup>	45553-2	45553-2
605976-3	Standard	4.10	708026-2	708031	708032	707063X	45553-2	45553-2
605976-4	Powr Lok	4.10	708026-2	708033 <sup>(9)</sup>	708034 <sup>(9)</sup>	707358X <sup>(9)</sup>	45553-2	45553-2
<b>1997 1/2 D3500 &amp; W3500 w/ABS</b>								
605977-1	Standard	3.54	708026-1	708027	708028	707063X	45553-3	45553-3
605977-2	Powr Lok	3.54	708026-1	708029 <sup>(9)</sup>	708030 <sup>(9)</sup>	707358X <sup>(9)</sup>	45553-3	45553-3
605977-3	Standard	4.10	708026-2	708031	708032	707063X	45553-3	45553-3
605977-4	Powr Lok	4.10	708026-2	708033 <sup>(9)</sup>	708034 <sup>(9)</sup>	707358X <sup>(9)</sup>	45553-3	45553-3
<b>1997 1/2 W2500</b>								
606056-1	Standard	3.54	708026-1	708027	708028	707063X	45553-1	45553-1
606056-2	Powr Lok	3.54	708026-1	708029 <sup>(9)</sup>	708030 <sup>(9)</sup>	707358X <sup>(9)</sup>	45553-1	45553-1
606056-3	Standard	4.10	708026-2	708031	708032	707063X	45553-1	45553-1
606056-4	Powr Lok	4.10	708026-2	708033 <sup>(9)</sup>	708034 <sup>(9)</sup>	707358X <sup>(9)</sup>	45553-1	45553-1
<b>1997 1/2 W3500</b>								
605975-1	Standard	3.54	708026-1	708027	708028	707063X	45553-2	45553-2
605975-2	Powr Lok	3.54	708026-1	708029 <sup>(9)</sup>	708030 <sup>(9)</sup>	707358X <sup>(9)</sup>	45553-2	45553-2
605975-3	Standard	4.10	708026-2	708031	708032	707063X	45553-2	45553-2
605975-4	Powr Lok	4.10	708026-2	708033 <sup>(9)</sup>	708034 <sup>(9)</sup>	707358X <sup>(9)</sup>	45553-2	45553-2
<b>1998-98 1/2 D2500</b>								
605985-1	Standard	3.54	708026-1	708027	708028	707063X	45553-1	45553-1
605985-2	Powr Lok	3.54	708026-1	708029 <sup>(9)</sup>	708030 <sup>(9)</sup>	707358X <sup>(9)</sup>	45553-1	45553-1
605985-3	Standard	4.10	708026-2	708031	708032	707063X	45553-1	45553-1
605985-4	Powr Lok	4.10	708026-2	708033 <sup>(9)</sup>	708034 <sup>(9)</sup>	707358X <sup>(9)</sup>	45553-1	45553-1
<b>1998-98 1/2 W2500</b>								
606064-1	Standard	3.54	708026-1	708027	708028	707063X	45553-1	45553-1
606064-2	Powr Lok	3.54	708026-1	708029 <sup>(9)</sup>	708030 <sup>(9)</sup>	707358X <sup>(9)</sup>	45553-1	45553-1
606064-3	Standard	4.10	708026-2	708031	708032	707063X	45553-1	45553-1
606064-4	Powr Lok	4.10	708026-2	708033 <sup>(9)</sup>	708034 <sup>(9)</sup>	707358X <sup>(9)</sup>	45553-1	45553-1

(7) See Ring Gear & Pinion Kits in XGI Catalog for ratio & tooth combinations.

(8) See Differential Case Assy Kits in XGI Catalog for spline data & ratios.

(9) Service Power Lok ratios 3.54 Case Assembly or Case Kit with 708054 Trak Lok.

Service Power Lok ratios 4.10 Case Assembly or Case Kit with 708052 Trak Lok.

The 708054 & 708052 Trak Lok uses 708051 Inner Parts Kit.

Note: See cross shaft view illustration on previous page for the difference between a Power Lok and a Trak Lok case.



## Dodge Model 80 /286 Rear Axles Bill of Material Table

Axle			Axle Kits				Shaft & Joint Assy.	
Bill of Material	Diff. Type	Ratio	Ring Gear & Pinion Kit <sup>(7)</sup>	Differential			Right Hand Shaft Assy.	Left Hand Shaft Assy.
				Case Assy. Kit <sup>(8)</sup>	Case Kit	Inner Parts Kit		
<b>1998-98 1/2 D3500 w/ABS</b>								
605983-1	Standard	3.54	708026-1	708027	708028	707063X	45553-2	45553-2
605983-2	Powr Lok	3.54	708026-1	708029 <sup>(9)</sup>	708030 <sup>(9)</sup>	707358X <sup>(9)</sup>	45553-2	45553-2
605983-3	Standard	4.10	708026-2	708031	708032	707063X	45553-2	45553-2
605983-4	Powr Lok	4.10	708026-2	708033 <sup>(9)</sup>	708034 <sup>(9)</sup>	707358X <sup>(9)</sup>	45553-2	45553-2
<b>1998-98 1/2 D3500 &amp; W3500 w/ABS</b>								
605984-1	Standard	3.54	708026-1	708027	708028	707063X	45553-3	45553-3
605984-2	Powr Lok	3.54	708026-1	708029 <sup>(9)</sup>	708030 <sup>(9)</sup>	707358X <sup>(9)</sup>	45553-3	45553-3
605984-3	Standard	4.10	708026-2	708031	708032	707063X	45553-3	45553-3
605984-4	Powr Lok	4.10	708026-2	708033 <sup>(9)</sup>	708034 <sup>(9)</sup>	707358X <sup>(9)</sup>	45553-3	45553-3
<b>1998-98 1/2 W3500</b>								
605982-1	Standard	3.54	708026-1	708027	708028	707063X	45553-2	45553-2
605982-2	Powr Lok	3.54	708026-1	708029 <sup>(9)</sup>	708030 <sup>(9)</sup>	707358X <sup>(9)</sup>	45553-2	45553-2
605982-3	Standard	4.10	708026-2	708031	708032	707063X	45553-2	45553-2
605982-4	Powr Lok	4.10	708026-2	708033 <sup>(9)</sup>	708034 <sup>(9)</sup>	707358X <sup>(9)</sup>	45553-2	45553-2

(7) See Ring Gear & Pinion Kits in XGI Catalog for ratio & tooth combinations.

(8) See Differential Case Assy Kits in XGI Catalog for spline data & ratios.

(9) Service Power Lok ratios 3.54 Case Assembly or Case Kit with 708054 Trak Lok.

Service Power Lok ratios 4.10 Case Assembly or Case Kit with 708052 Trak Lok.

The 708054 & 708052 Trak Lok uses 708051 Inner Parts Kit.

Note: See cross shaft view illustration on previous page for the difference between a Power Lok and a Trak Lok case.

# Dodge Model 80 /286 Rear Axles Variable Parts Listing

Kits & Parts - Use With All Applications							
Description & Item Number (Refer to "Exploded View" at the front of this section)			Bills of Material				
			605592	605593 605594	605595	605596	605718
1	Seal – Pinion Oil	8	43504	43504	43504	43504	43504
2	KIT – Carrier Cover	-	707231X	707329X	707329X	707231X	707329X
3	Carrier Cover	13	42434	45559	45559	42434	45559
4	Seal – Hub	31	35256	35256	43146	43146	35256
5	Spindle Nut	35	39695	39695	39695	39695	47163
6	Flange Head Screw	39	43124	43124	43124	43124	43124
			<b>605788</b>	<b>605789 605790</b>	<b>605791</b>	<b>605792</b>	<b>605902</b>
1	Seal – Pinion Oil	8	43504	43504	43504	43504	43504
2	KIT – Carrier Cover	-	707231X	707329X	707229X	707231X	707231X
3	Carrier Cover	13	42434	45559	45559	42434	42434
4	Seal – Hub	31	35256	35256	43146	43146	35256
5	Spindle Nut	35	47163	47163	47163	47163	47163
6	Flange Head Screw	39	43124	43124	43124	43124	43124
			<b>605903 605904</b>	<b>605905</b>	<b>605906</b>	<b>605975</b>	<b>605976 605977</b>
1	Seal – Pinion Oil	8	43504	43504	43504	43504	43504
2	KIT – Carrier Cover	-	707329X	707329X	707231X	707231X	707329X
3	Carrier Cover	13	45559	45559	42434	42434	45559
4	Seal – Hub	31	35256	47507	43146	35256	35256
5	Spindle Nut	35	47163	47163	47163	47163	47163
6	Flange Head Screw	39	43124	45720	45720	45720	45720
			<b>605982</b>	<b>605983 605984</b>	<b>605985</b>	<b>606056</b>	<b>606064</b>
1	Seal – Pinion Oil	8	46411	46411	46411	43504	46411
2	KIT – Carrier Cover	-	707231X	707329X	707329X	707231X	707231X
3	Carrier Cover	13	42434	45559	45559	42434	42434
4	Seal – Hub	31	35256	35256	47507	47507	47507
5	Spindle Nut	35	47163	47163	47163	47163	47163
6	Flange Head Screw	39	45720	45720	45720	45720	45720